

Operating instructions

Landscape light

Landscape light XL

Original operating instructions



Contents

1 Welcome.....	3
to the world of milling, kneading, baking, and pasta-making!	3
2 For your safety	4
Table of symbols	4
Intended use.....	4
Basic rules.....	4
Safety information	4
3 Product guide.....	6
Product description	6
Technical data	6
4 Scope of delivery.....	8
Setting up the device	9
Assembling the device.....	9
5 Fuel to be used.....	10
6 Filling and firing up.....	12
Filling capacity	13
7 Cleaning.....	16
8 Maintenance.....	17
9 Troubleshooting	18
10 Disposal	21
11 Accessories	22
12 Warranty.....	25

1 Welcome...



to the world of milling, kneading, baking, and pasta-making!

Häussler stands for doing it yourself. With our devices, you can create wonderful delicacies with a second-to-none taste. Immerse yourself in the world of milling, kneading, baking, barbecuing, and pasta-making.

Häussler stands for uncompromising quality – Made in Germany. Decades of experience and thousands of devices shipped worldwide speak for themselves.

Häussler stands for customer service. Even after you've made a purchase, we will not hesitate to provide you with support. We want you to be happy with your device for a long time, receive new helpful hints now and again, and discover fresh recipe ideas at Häussler.





You have decided to purchase our landscape light, a fire under glass for your garden. With its contemporary look and the flame generated, the light adds an unforgettable, appealing atmosphere to any environment.

Plenty of pleasure and always successful.

The Family Häußler

2 For your safety

Table of symbols

Symbol description	
	Danger symbol
	Prompt to action
	Information
	Bullet point

Tab. 1: Table of symbols

Intended use

The landscape light meets the prescribed, product-specific safety regulations.

The landscape light is only intended to be used as an outdoor light. The use of any fuel other than wood pellets is prohibited. Any other use shall be considered improper use. Karl-Heinz Häussler GmbH shall not be liable for any damage to property or persons resulting from improper use of the product.

The supplementary products recommended by Häussler are the only ones that may be used.

Basic rules

- ▶ Carefully read the operating instructions before you commission the device.
- ▶ Observe the safety information and warnings in the operating instructions.
- ▶ Only operate the device when it is in perfect condition.
- ▶ Keep the operating instructions available in the vicinity of the device.
- ▶ Always include these operating instructions when selling this device to a third party.
- ▶ Conduct a visual inspection before commissioning every time the device is used.

Safety information

Risk of fatality from explosion

- ▶ Never use easily and highly flammable liquids such as denatured alcohol, etc.
- ▶ Never use an accelerant on pellets that have been fired up and are warm.

⚠ Risk of fatality from smoke

- ▶ Only use the landscape light outdoors.

⚠ Risk of injury due to high weight

- ▶ Transport the device with care due to its high weight.
- ▶ Before picking it up, make sure that you can handle the weight.
- ▶ Two people should carefully lift the device.
- ▶ Only set the device down on a stable surface.

⚠ Risk of burns from heated components

- ▶ Do not leave the device unattended during and after operation.
- ▶ Set up the device out of the reach of children under 14 and always supervise children in the vicinity of the device. Do not leave infants, children, or animals unattended in the vicinity of the landscape light.
- ▶ Let the landscape light cool down completely before touching it.

⚠ Risk of burns from high flames

- ▶ Do not wear loose-fitting clothes.
- ▶ Persons with long hair should tie it back.

⚠ Risk of fire from high flames

- ▶ Only operate the landscape light in areas without roofs.
- ▶ Maintain a minimum distance of 1.5 m from flammable materials when using the landscape light.

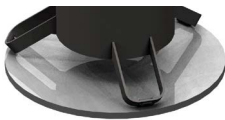

Risk of fire from hot components

Please note that the landscape light also radiates heat downwards. Protect the surface beneath the landscape light by covering it with a heat-resistant plate.

3 Product guide

Product description

You have purchased a very high-quality outdoor light: our Landscape light. This outdoor light is simple to operate, easy-care, and requires virtually no maintenance. With the relevant accessories, it can also be used as a barbecue.

Technical data

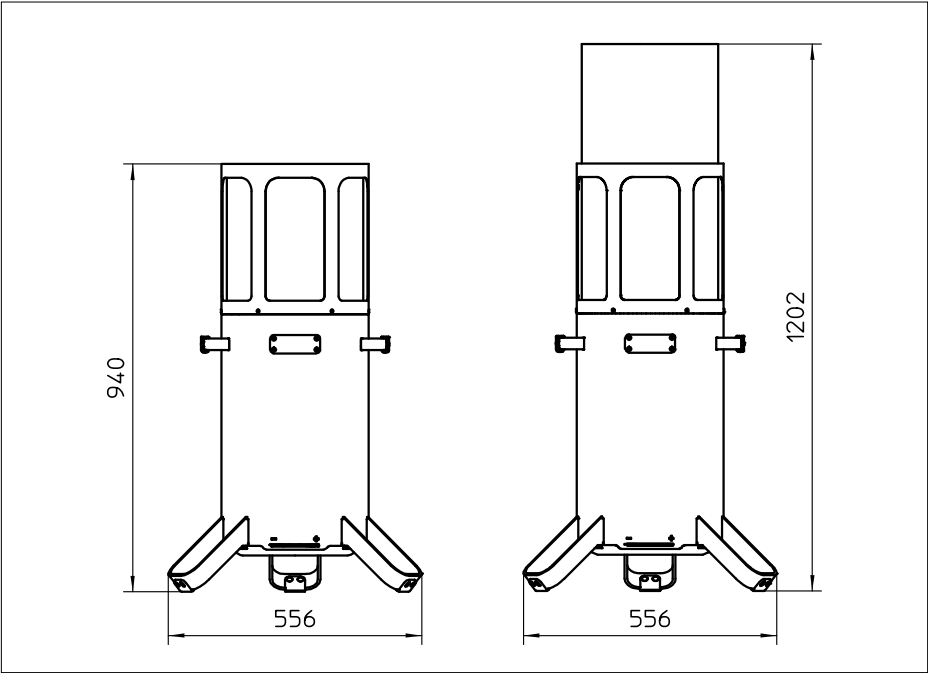

Name	Value
Pillar diameter	323 mm
Landscape light height	940 mm
Landscape light XL height	1,212 mm
Base diameter	605 mm
Weight	29 kg
Filling capacity	Max. 9 kg

Tab. 2: Technical data

Firing values	Value
Rated thermal input	5.2 kW/kg
Carbon content	3.49%
Exhaust mass flow rate	31.3 g/s
Dust	2.80 mg

Tab. 3: Output and emissions

4 Scope of delivery

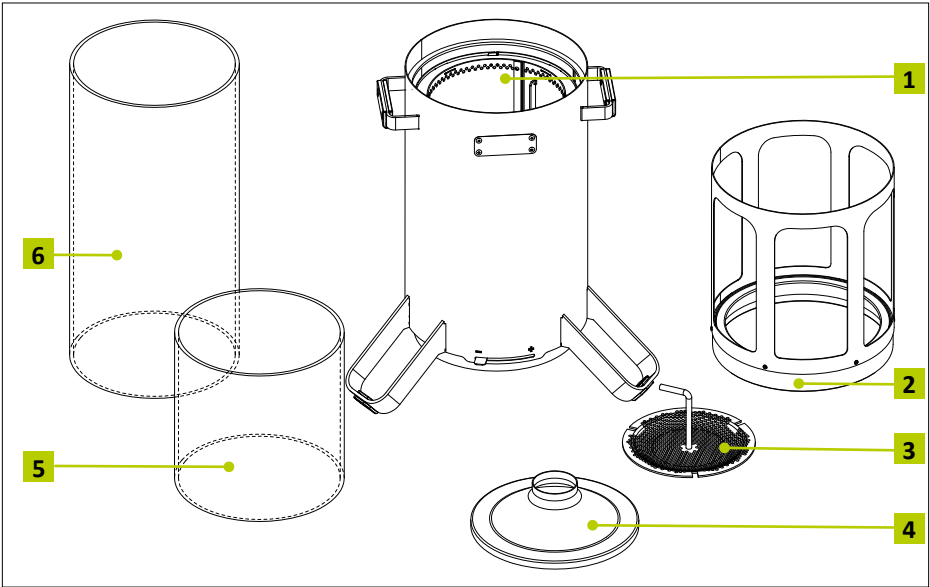

No.	Designation
1	Base
2	Upper section
3	Grate
4	Burner cover
5	Glass insert
6	Glass insert XL

Tab. 4: Scope of delivery

i Please note that the scope of delivery contains either the short glass insert or the XL glass insert, depending on the version ordered.

Setting up the device

- ▶ Use Table 4 “Scope of delivery” to help you check the delivery for completeness.
- ▶ Two people should carefully lift the device due to its high weight. Always set it down on a stable, even work surface.
- ▶ Create enough room to work on the device.

Assembling the device

- ▶ Pick up the base **5** and place it on a solid, even surface.
- ▶ The grate **4** is already inside the base, in the burner head.
- ▶ The burner cover **3** is already on the burner head in the base. Push the burner cover back and forth to check whether or not it completely covers the burner.
- ▶ Unpack the separately packaged upper section **2**.

i To smoothly place the upper section **2** on the base, **5** use multi-purpose grease for high temperatures.

- ▶ Use a cloth or your finger to apply a thin coat of multi-purpose grease for high temperatures to the notch in the frame.

- ▶ Place the upper section **2** onto the base **5**. Press down onto the base until it stops.

- ▶ Unpack the separately packaged glass insert **1** and put it on the upper section **2**. Caution: Fragile

i Your landscape light is now set up and ready to use.

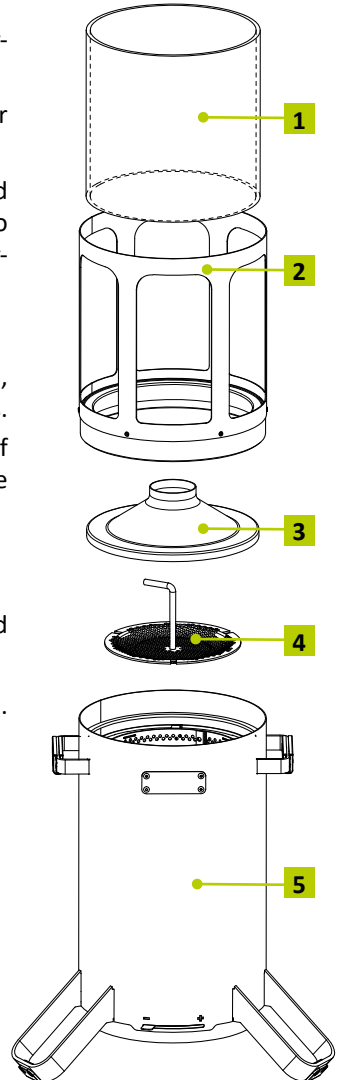

5 Fuel to be used

WARNING

Risk of fatality from explosion

Darting flame

- ▶ **Never use easily and highly flammable liquids such as denatured alcohol, etc.**
- ▶ **Never use an accelerant on pellets that have been fired up and are warm.**

CAUTION

Risk of burns from catching fire

Severe burns on entire body

- ▶ **Do not wear loose-fitting clothes.**
- ▶ **Persons with long hair should tie it back.**

- ▶ Use only class A1 and A2 wood pellets for private households in accordance with European standard EN 14961-2.



What are wood pellets?

Wood pellets are standardised, cylindrical products of compression made from dried, untreated residual wood (sawdust, shavings, residual wood from forests) with a diameter of approx. 6 mm. They are produced under high pressure without the addition of any chemical binding agents, and have a calorific value of approx. 5 kWh/kg. In other words, the energy content of one kilogram of pellets is approximately equal to one-half litre of heating oil.

 The use of any other fuel is prohibited.

 The burning of waste with this product is prohibited.



Helpful hint: Pellet class selection

Häussler recommends that you use class A1 wood pellets, since they have a lower ash content after burning.

Burning aids

Only use wood shaving bundles soaked in wax as a burning aid. They are toxin-free, have a neutral odour and taste, and burn without leaving residue behind.



Helpful hint: Optimal flame ignition

With Häussler pellet starter, you can optimally ignite the flame.

6 Filling and firing up

WARNING

Risk of fatality from explosion

Darting flame

- ▶ **Never use easily and highly flammable liquids such as denatured alcohol, etc.**
- ▶ **Never use an accelerant on pellets that have been fired up and are warm.**

WARNING

Risk of fatality from smoke

- ▶ **Only use the landscape light outdoors.**

CAUTION

Risk of burns from catching fire

Severe burns on entire body

- ▶ **Do not wear loose-fitting clothes.**
- ▶ **Persons with long hair should tie it back.**

CAUTION

Risk of burns from heated components

Severe burns on arms and legs

- ▶ **Do not leave the device unattended during operation.**
- ▶ **Set up the device out of the reach of children under 14 and always supervise children in the vicinity of the device. Do not leave infants, children, or animals unattended in the vicinity of the barbecue.**
- ▶ **Let the barbecue cool down completely before touching it.**
- ▶ **When handling the barbecue, wear barbecue mitts.**
- ▶ **Use proper barbecue tools with long, heat-resistant handles.**

 Ensure that the landscape light is in a stable, even upright position.

 Before filling it with pellets, make sure that the grate is in the firing chamber.

 Before refilling with wood pellets, make sure that the residual ashes from the previous fire has been removed from the firing chamber and the grate is clean.

Filling capacity

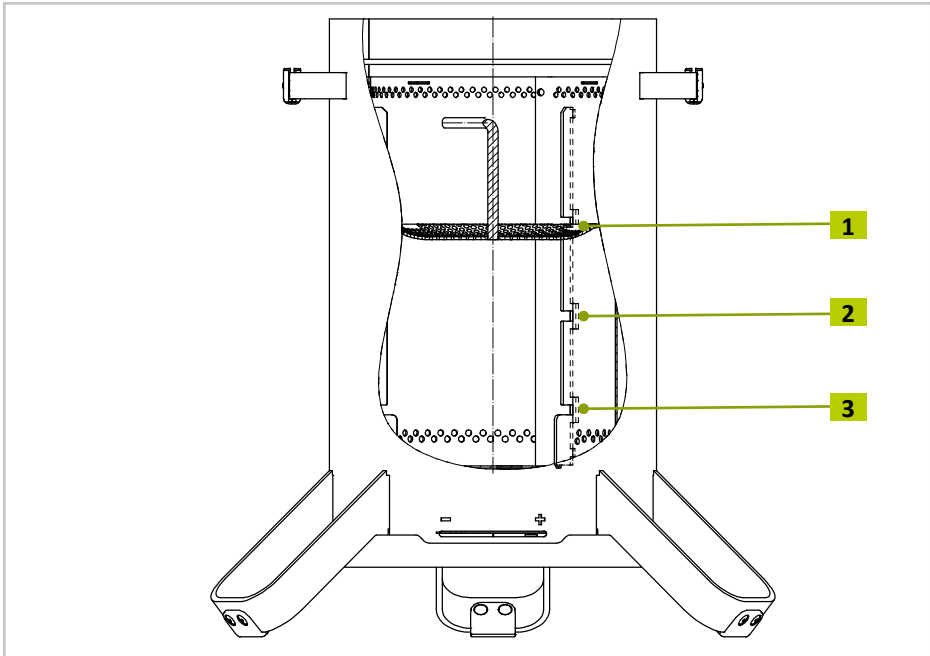

Level	Filling capacity	Burning period
1	approx. 3 kg	approx. 1 hour
2	approx. 6 kg	approx. 2 hours
3	approx. 9 kg	approx. 3 hours

i The times are only approximate since the burning period may vary with the slider setting and natural draught.

i When the glass insert XL is used, the burning period is shorter due to the natural draught.



1. Setting the burning period

By shifting the grate, you can set the burning period in accordance with the table on page 13.



2. Regulating the air supply

For the first 15 minutes, set the air supply to maximum to optimally ignite the pellets.

By regulating the air supply, you influence the intensity of the flame.



3. Filling

Remove the upper section and burner cover from the landscape light and store them out of the way.



4. Filling capacity

Fill the firing chamber with pellets to the top edge of the grate guide.



5. Adding starter

Pour some Häussler pellet starter (approx. 20 - 30 ml) over the wood pellets.



6. Firing up

Ignite a wood shaving bundle and put it on the pellets.



7. Covering

Once the wood pellets have ignited, place the burner cover in the middle of the firing chamber.



8. Short Landscape light

By putting on the short glass insert and the upper section, you will create an attractive outdoor lighting ambience.



11. Expand to Landscape light XL

Only touch the short glass insert when wearing barbecue mitts. Place the hot short glass insert on a heat-resistant surface only.



12. Landscape light XL

Carefully put on the XL glass insert.
If you've just used the barbecue or short landscape light, be careful with hot components and use barbecue mitts.

7 Cleaning

CAUTION

Risk of burns from heated components

Severe burns on arms and legs

- ▶ **Let the glass insert cool down completely before cleaning it.**
- ▶ **Let the landscape light cool down completely before touching it.**

- ▶ After each use, remove the ashes from the firing chamber of the landscape light.
- ▶ Always let the firing chamber cool down before emptying the ashes.
- ▶ After each use, clean the firing chamber, housing, and the glass insert if necessary.



Helpful hint: Cleaning

- ▶ We recommend using Häussler universal cleaning agent, suitable for glass and stainless steel.

Item number: 302251

8 Maintenance

- ▶ Before each use, check the landscape light for damage. In case of damage, replace the defective part(s) before firing up again.
- ▶ Remove the old grease from the upper section with a cloth at regular intervals and apply a new layer of multi-purpose grease for high temperatures.



Helpful hint: Multi-purpose grease for high temperatures

For maintenance and care, we recommend using the transparent multi-purpose grease for the Häussler pellet barbecue. Ideal for greasing the aluminium upper part so it is easier to attach and does not catch – even at high temperatures. Protects and preserves the material.

Item number: 304013

9 Troubleshooting

Problem	Cause	Resolution
No flame visible after firing up	Flame extinguished	<ul style="list-style-type: none"> ▶ Carefully remove the upper section, including the glass insert and burner cover, and fire up again.
Flame is too small	The burner head and grate were not cleaned	<ul style="list-style-type: none"> ▶ Let the pellets burn out. Wait until the device has cooled down before resolving the problem. ▶ Empty the wood pellets, clean the burner head and grate, refill, and fire up.
	The grate is missing	<ul style="list-style-type: none"> ▶ Let the pellets burn out. Wait until the device has cooled down before resolving the problem. ▶ Empty the wood pellets, insert the grate, refill, and fire up.
	Combustion air supply is not completely free	<ul style="list-style-type: none"> ▶ Let the pellets burn out. Wait until the device has cooled down before resolving the problem. ▶ Empty the wood pellets, clear the opening for the combustion air supply, refill, and fire up.
Flame suddenly goes out	Strong wind	<ul style="list-style-type: none"> ▶ Move to a place protected against wind ▶ Fire up the pellets again.

Tab. 5: Troubleshooting

For other problems, ring us under the following service telephone number:

+49 73 71/93 77-13

What to do if the landscape light unexpectedly goes out

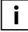
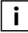
-  If a gust of wind unexpectedly blows out the landscape light's flame, dense smoke may be produced.
 - ▶ In case of wind, move the landscape light to a place that is protected against the wind or use a wind deflector.
-  Fire up the barbecue again as described in the following.

WARNING

Risk of fatality from explosion

Darting flame

- ▶ **Never use easily and highly flammable liquids such as denatured alcohol, etc.**
- ▶ **Never use an accelerant on pellets that have been fired up and are warm.**

CAUTION

Risk of burns from catching fire

Severe burns on entire body

- ▶ **Wear barbecue mitts.**
- ▶ **Use a long barbecue tong.**

CAUTION

Risk of burns from heated components

Severe burns on arms and legs

- ▶ **Wear barbecue mitts.**
- ▶ **Remove bowls of water, etc. before lifting off the attachments.**
- ▶ **If necessary, two people should lift off the attachments.**



1. Lifting off the attachments

Put on barbecue mitts.

Avoid heated components.

Lift off the tall glass insert and set it down on a fire-resistant surface.



2. Wood shaving bundle

Use a **long barbecue tong** to grasp a wood shaving bundle.

Ignite the bundle.

For your own protection, it is essential to wear barbecue mitts.



3. Burning process

i As soon as the burning wood shaving bundle is held in the smoke-filled glass insert, the smoke will die down.

i This effect happens because the developing gases trigger the burning process again.

⚠ **Caution! This causes the air in and above the glass insert to heat up. Risk of burns!**



4. Firing up the landscape light again

Drop the burning bundle into the firing chamber.

i Act quickly, since the temperature can rise quickly and possibly extinguish the burning bundle.

For other problems, ring us under the following service telephone number:

+49 73 71/93 77-13

10 Disposal

- ▶ Keep the landscape light clean at all times and when disposing of residual materials.
- ▶ Do not remove the ashes until they have completely cooled down.
- ▶ Only use the intended containers made of metal or noncombustible materials to dispose of the residual waste or ashes.

i The local regulations for disposal apply.

- ▶ Dispose of used devices in suitable collection systems.

i Used devices contain valuable recyclable materials that can be used again.



11 Accessories

Barbecue attachment



Ten minutes after being fired up, the Häussler barbecue is ready for use. Barbecue trouble-free and carbon-neutral – even on your balcony or in an urban environment.

Material	Cast iron
Barbecue attachment outer dimensions W x H	13 x 59 cm
Weight	10 kg

Item number: 304001

Häussler pellet starter



Our pellet starter is made from 100% raw materials from plants. It contains no paraffins and burns cleanly without any soot. We avoid using fragrances and colourants.

Item number: 301011

Glass insert XL



Glass insert XL creates an attractive atmosphere.

Material	Glass
Glass insert outer dimensions W x H	30 x 60 cm
Weight	9.6 kg

Item number: 304005

Wood pellets



Our wood pellets consist of dried, untreated wood and are produced without the addition of any chemical binding agents. The A1 quality class guarantees clean burnup and low ash residue.

Contents	Item number	
9 kg	302447	5.90
15 kg	302442	8.90

Swissflame fire-lighter



Wood shaving bundle soaked in wax. For wood-burning ovens, tile ovens, wood-burning kitchen stoves, fireplaces, barbecues. Burning period 8-10 minutes. Burns toxin-free, neutral odour and taste without leaving residue behind. May be stored indefinitely. 600 g / contents approx. 50 pc.

Item number: 201808

Stainless steel maintenance spray



Developed specifically for the cleaning, maintenance, and protection of matt and polished stainless steel surfaces both indoors and outdoors. Anti-static effect. Removes and prevents fingerprints and greasy films. Also cleans larger surfaces without leaving stripes, makes treated surfaces look like new, and leaves a long-lasting protective film behind that makes water drip off.

Contents 50 ml

Item number: 101186

Häussler transparent multi-purpose grease



Transparent multi-purpose grease for the Häussler pellet barbecue. Ideal for greasing the aluminium upper part so it is easier to attach and does not catch – even at high temperatures. Protects and preserves the material. Contents 150 g.

Transparent multi-purpose grease in NLGI class 2; NSH/H1

Use in temperature range: -20 °C to +150 °C

Item number: 304013

Barbecue mitts



Stylish Häussler barbecue mitts are made of 100% cotton and provide reliable protection against heat and flying sparks. They are perfect for refilling charcoal, while grilling, or when changing tools while the barbecue is on.

Item number: 304008

Barbecue/landscape light cover



Keeps stormy weather away from your Häussler barbecue. And effortlessly ensures a long service life.

Barbecue cover:

Item no.: 3/304006

Landscape light cover:

Item no.: 3/304007

You will find these accessories and others at www.backdorf.de and in our Häussler catalogues.

12 Warranty

You will receive a 12-month factory warranty on your device, beginning on the date of the invoice.

Karl-Heinz Häussler GmbH produced your device in accordance with the technological state of the art. All devices that leave our factory are made from high-quality materials and were thoroughly inspected.

Warranty services

Dear Customers,

Thank you for the trust you have shown in Häussler by purchasing your new device. We are pleased that you decided in favour of quality. The warranty period is 12 months from the invoice date; the warranty coverage is legally fixed at 24 months. Warranty services do not lead to an extension of the warranty period.

The following are excluded from the warranty:

- All wearing parts such as drive belts,
- fragile parts,
- damage that has resulted from improper use,
- damage that has resulted from ignoring the operating instructions, and
- devices whose serial number has been changed, damaged, or removed.

We will remedy defects free of charge if they

- are proven to be due to material or processing faults on the manufacturer side,
- were immediately reported after discovery, and
- were reported to us within the warranty period.

We will invoice all services, e.g., repairs, that we provide in addition to warranty services. They include transport, packaging, and travel time to and from the site. Parts that have been replaced will become our property or must be returned to us free of charge. Further or other claims, in particular those for compensation for damage caused outside the products, are excluded unless manufacturer liability is legally mandated.

Post-warranty period service

Of course we will also be there for you after the warranty period expires. In the event of function-related faults, send us a description of the problem. Please include your telephone number for further questions. You can also contact our customer service centre.

Service telephone number: +49 73 71/93 77-13

Our currently valid terms & conditions are a further basis. The place of fulfilment and jurisdiction is 88499 Riedlingen, Germany.

Visit our baking centre...

Under the name of Häussler, we have devoted our work to the pleasure of doing it yourself for more than 35 years.

We are a family-run company with around 100 employees and our headquarters is in Heiligkreuztal/Upper Swabia. We produce our devices there, including our wood-burning ovens, for example.

Why not visit us in our baking centre! That is what we affectionately call our showrooms and sales rooms. They invite visitors to linger, and you can experience your favourite products first-hand there. The Häussler family and our expert employees will be happy to answer your questions and show you our stone ovens, dough mixing machines, pasta machines, etc. in everyday use. We also offer many baking and pasta-making demonstrations the whole year 'round. You'll see: a visit to our baking centre is always worthwhile.

You can also visit our baking centre online at www.backdorf.de

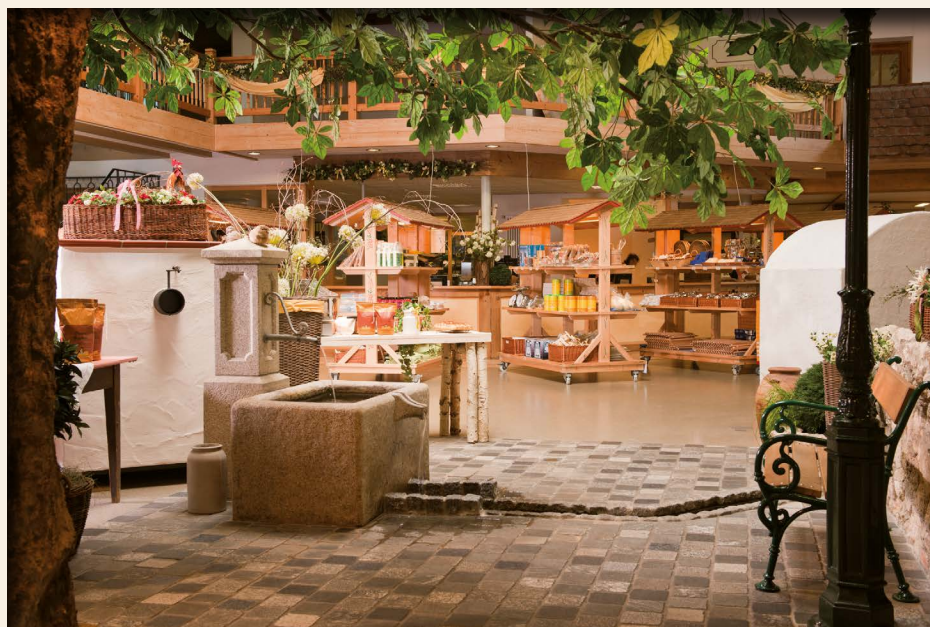

Our service for you

- Information on other destinations and places to stay in the area
- Cosy consulting rooms
- Children's play area
- Guest toilets with changing tables
- Seating
- Loading service
- On-site service for your devices on our premises

We also offer you

- Seminar rooms with projectors
- Booking service for accommodations
- Regularly schedules baking, pasta-making, and smoking demonstrations
- Tours for groups and associations upon request

Directions to our baking centre



By train or plane

Enjoy the trip to Häussler without stress or traffic. We will gladly pick you up from Riedlinger Station or the airport in Mengen. Simply ring us up!

HÄUSSLER

Karl-Heinz Häussler GmbH
Nussbaumweg 1
88499 Heiligkreuztal, Germany
Telephone +49 73 71/93 77-0
Fax + 49 73 71/93 77-40
Email: info@backdorf.de

Version: 30/10/2019